

TRT MADE POSSIBLE

STEEL WHEELS

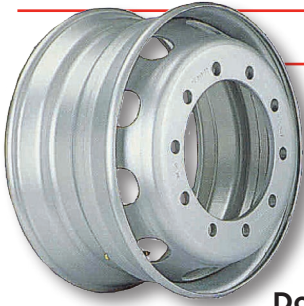

TRT Part No	Wheel Size	Offset	Bore	Stud	PCD
176056	17.5x6.00"	133mm	176mm	10 ISO	225mm
176766	17.5x6.75"	145mm	176mm	10 ISO	275mm
197577	19.5x7.50"	151mm	221mm	10 ISO	275mm
228313	22.5x8.25"	165mm	281mm	10 ISO	335mm
228283	22.5x8.25"	165mm	281mm	10 ENG	335mm

Double Cap & English Stud Hole

ISO Stud Hole

Tubeless Wheel

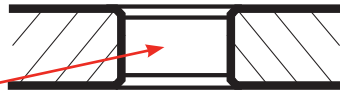

Countersunk Hole
 US / Jap DCN
 18° Taper
 DIN DCN Hole ID 27- 32 mm 18° Taper
 English Hole ID 25.4- 31.5mm 40° Taper
 Hole ID 32.2- 37mm

No Countersink (Square)
 ISO Hole ID 26mm



English Wheel Nut
 80° Cone 7/8 BSF 11 TPI Thread
 1-1/4" AF Across Flats (32mm)
 Also comes as flat nut for back up



ISO Flange Head Wheel Nut
 Swivel Flange Face
 M22 x 1.5 thread
 33mm AF - 31mm High



Wheel Stud Back Nut Style

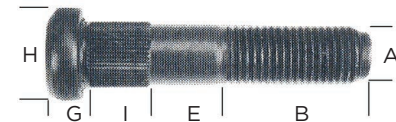

Wheel Stud Head Style

Stud Dimensions

A	Thread Diameter
B	Thread Length
C	Thread Diameter
D	Thread Length
E	Shoulder Length Diameter
F	Flange Length Diameter
G	Shoulder Length
H	Head Diameter
I	Knurled Length Diameter

ALLOY WHEELS



TRT Part No	Rim Size	Offset	Stud	PCD
AGR370	17.5 x 6.00	133	10 ST 26mm	225mm
AGR365	17.5 x 6.75	141	10 ST 26mm	225mm
AGR364	19.5 x 7.50	155	8 ST 26mm	275mm
AGR362	22.5 x 8.25	168	10 ST 26mm	335mm
AGR388	22.5 x 8.25	168	10 ST 32mm	335mm



Dual Sleeved Nut 32mm
 0526054141