

SHOCK ABSORBER

Shock Absorbers reduce potentially damaging shock and vibration. This reduces wear to high maintenance areas such as suspension and drivetrain, as well as reducing driver fatigue, and cargo damage. From its first shock absorber made in 1907, Gabriel has become a major OEM Supplier to the world market with its Fleetline range of heavy duty truck and trailer shock absorbers. Established in 1983 Powerdown started with shock absorbers designed to handle Australia's extreme conditions, and today has a full range for our market.



Shock Absorbers should be checked as part of regular maintenance. Visual checks are: Leaks, Broken Mounts, Extruded or Worn Bushings.

Shock Absorbers work hard, and so run hot. A shock absorber that runs cold is not working.

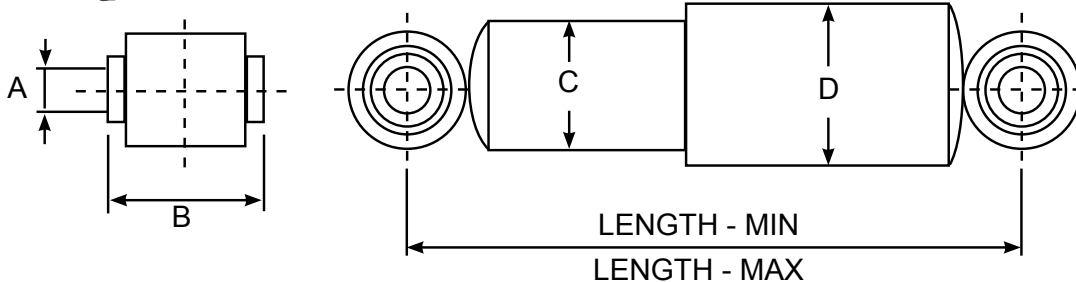
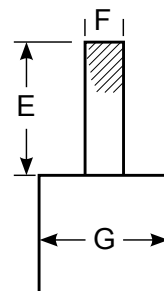

To identify a shock absorber measure length centre line to centre line extended and compressed. Note style of the eye/stud and also the measurements of A, B, C, D.

